

CRG



CRG's
Safe, High Energy

Li-Metal Cells

- Lighter weight
- Longer run times
- Extended endurance
- Extreme low temperature
- Man portable power
- Unmanned systems
- Domestic supply Chain

Ordering Information:

Web: www.crgrp.com/products

Email: sales@crgrp.com

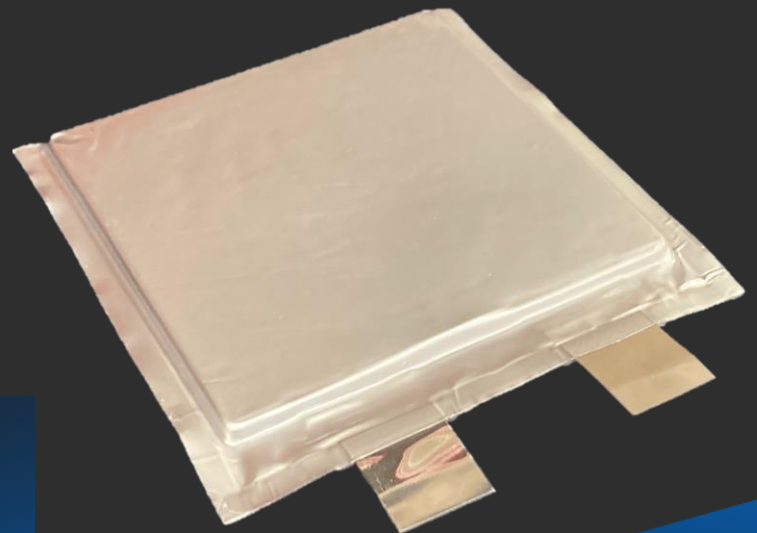

Example Pouch Cell

Example Pouch Cell Specifications

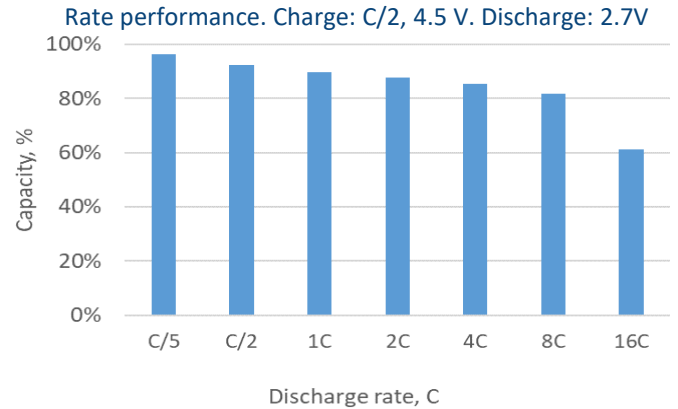
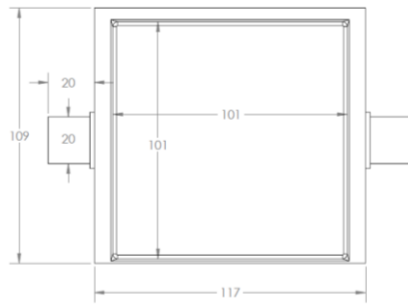

Preliminary Specifications

Model	EAB-1069855
Capacity (C/20)	6.1 Ah
Specific Energy (C/20)	260 Wh/kg
Capacity (C/5)	6 Ah
Voltage	3.8 V
Voltage Range	2.7-4.5 V
Energy	23.2 Wh
Weight	90 g
Rate capability	97 A, 16C
Temperature	-50 to +55°C
Cycle Life	>400 cycles to 80% capacity
Size	101 x 101 x 3.8 mm

Temperature performance. Charge: C/2, 4.5 V. Discharge: C/2, 2.7V

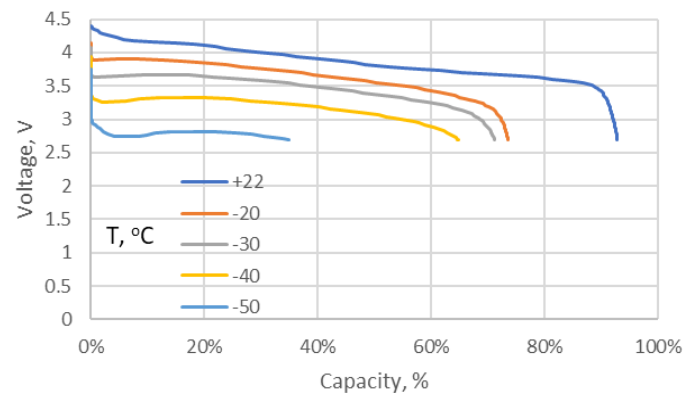

Cycle life, room temperature. Charge: C/5, 4.5 V. Discharge: C/5, 2.7V

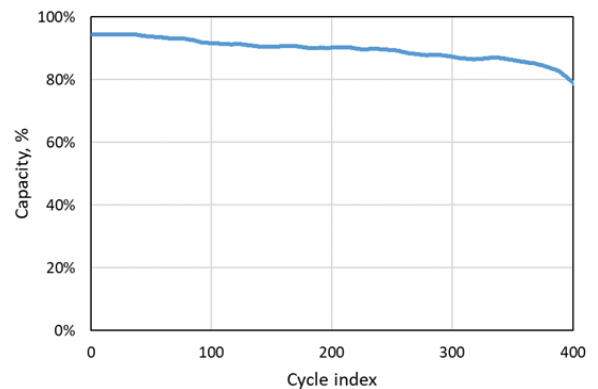

Customizable cells range:
30 x 30 mm –
100 x 100 mm

